

CABLE CLIPS & CLAMPS



WCK / MWCK Adhesive Mount Clips

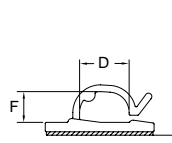
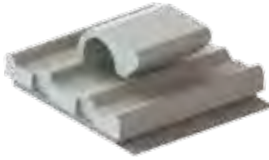

Figure 1

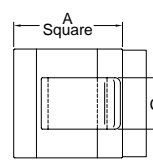

Figure 2

Specifications:

- Material: UL94 V-2 Nylon 6/6
- Color: Natural

Features:

- To hold wires, cords, or cables in place

Item No.	Figure	Approval	A		C		D		F		Bulk Pack Qty.
			In	mm	In	mm	In	mm	In	mm	
WCK-180-01A-RT	1		0.630	16.0	0.310	7.9	0.340	8.6	0.160	7.0	1000
WCK-280-01A4-RT	1	—	0.750	19.0	0.390	10.0	0.260	6.5	0.220	8.8	1000
WCK-460-01A-RT	1		0.990	25.1	0.470	11.9	0.450	11.4	0.280	11.7	1000
MWCK-460-01A4-RT	2	—	0.750	19.0	0.470	11.9	0.450	11.4	0.280	11.6	1000
WCK-720-01A-RT	2	—	1.000	25.4	0.470	11.9	0.720	18.3	0.540	17.9	1000

WCA Adhesive Mount Clips

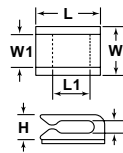

Figure 1

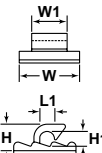

Figure 2

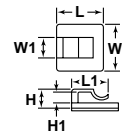

Figure 3

Specifications:

- Material: UL94 V-2 Nylon 6/6
- Color: Natural

Features:

- Self-adhesive wire clip is designed to support lightweight wire bundles when properly applied on any clean, smooth, grease-free surface

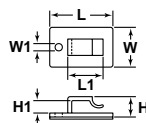

Figure 4

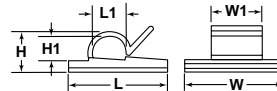

Figure 5

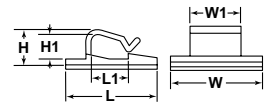

Figure 6

Item No.	Figure	L		L1		W		W1		H		H1		Bulk Pack Qty.
		In	mm	In	mm	In	mm	In	mm	In	mm	In	mm	
WCA001A	1	0.510	13.00	0.354	9.00	0.370	9.50	0.260	6.50	0.200	5.20	0.110	2.80	100
WCA002A	2	0.630	16.00	0.190	4.80	0.610	15.50	0.354	9.00	0.270	6.80	0.190	4.80	100
WCA003A	3	0.630	16.00	0.490	12.50	0.630	16.00	0.354	9.00	0.340	8.70	0.150	3.70	100
WCA004A	4	1.060	27.00	0.580	14.80	0.670	17.00	0.120	3.10	0.340	8.70	0.220	5.50	100
WCA005A	5	0.750	19.00	0.230	5.90	0.750	19.00	0.394	10.00	0.280	7.20	0.190	4.90	100
WCA006A	1	0.630	16.00	0.470	11.90	0.620	15.80	0.354	9.00	0.354	9.00	0.230	5.80	100
WCA007A	6	1.060	26.80	0.470	11.90	1.040	26.50	0.480	12.30	0.460	11.70	0.330	8.30	100

RWS / RWSB Round Clamp

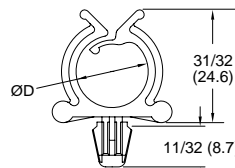

Figure 1

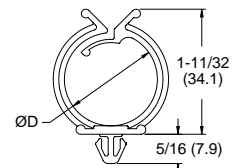

Figure 2

Specifications:

- Material: Nylon 6/6
- Color: Natural

Features:

- Gathers and routes cables & wires
- Push mount design allows for fast installation
- Adhesive base makes installation quick & easy

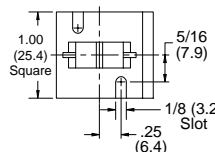

Figure 3



Item No.		Mounting Method	Approval	Figure	Mounting Hole		Panel Thickness		Holding Ø D		Depth		Color	Bulk Pack Qty.
UL94 V-2	UL94 V-0				in	mm	in	mm	in	mm	in	mm		
RWS-10-01	RWS-10-19	Snap-In		1	Ø.250	6.4	.030 - .060	0.8 - 1.5	0.625	15.9	0.297	17.5	Natural	1000
RWS-10-01BK	—	Snap-In		1	Ø.250	6.4	.030 - .060	0.8 - 1.5	0.625	15.9	0.297	17.5	Black	1000
RWS-16-01	RWS-16-19	Snap-In		2	.250 Square	6.4	.058 - .064	1.5 - 1.6	1.000	25.4	0.297	17.5	Natural	1000
RWS-16-01BK	—	Snap-In		2	.250 Square	6.4	.058 - .064	1.5 - 1.6	1.000	25.4	0.297	17.5	Black	1000
RWSB-10-01A-RT	—	Adhesive	—	3	—	—	—	—	0.625	15.9	1.000	25.4	Natural	1000
RWSB-16-01A-RT	—	Adhesive	—	3	—	—	—	—	1.000	25.4	1.000	25.4	Natural	1000
RWSB-10-01	—	Screw	—	3	—	—	—	—	0.625	15.9	1.000	25.4	Natural	1000
RWSB-16-01	—	Screw	—	3	—	—	—	—	1.000	25.4	1.000	25.4	Natural	1000